

THE BEACH ^{H22} *Helsingborg*

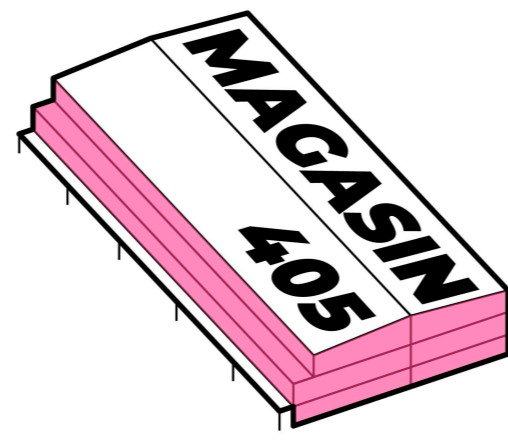

VALUE THE HERITAGE (BRICK FACADE)

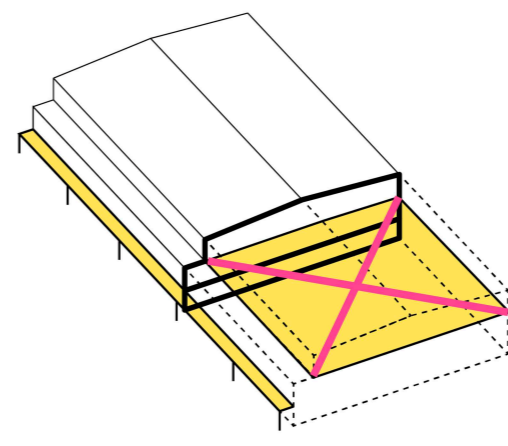

LEVEL ELIMINATION

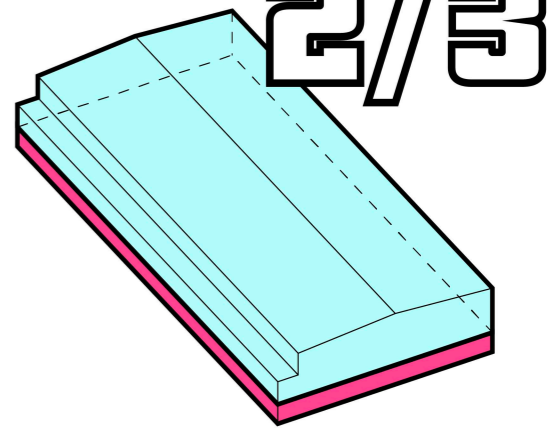

TWO DIFFERENT ATMOSPHERES

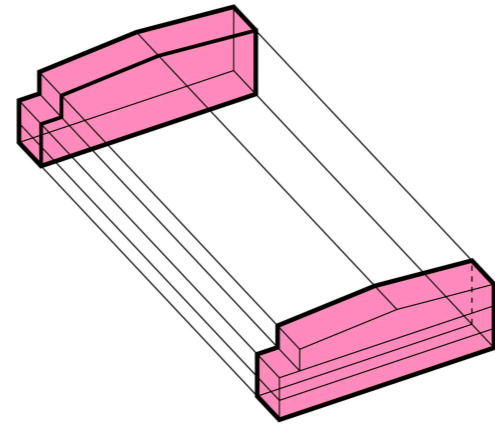

EQUIPPED VOLUMES

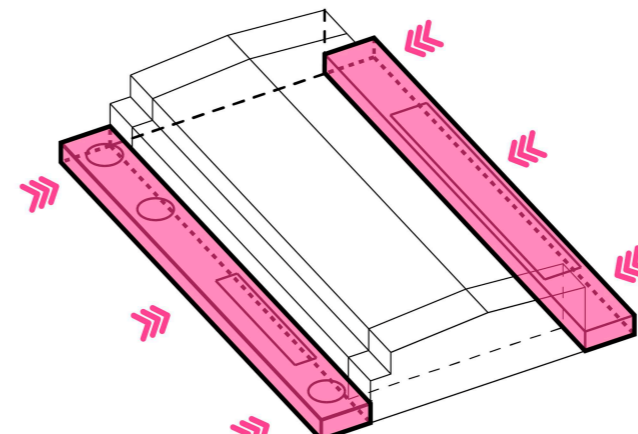

NEW SILL

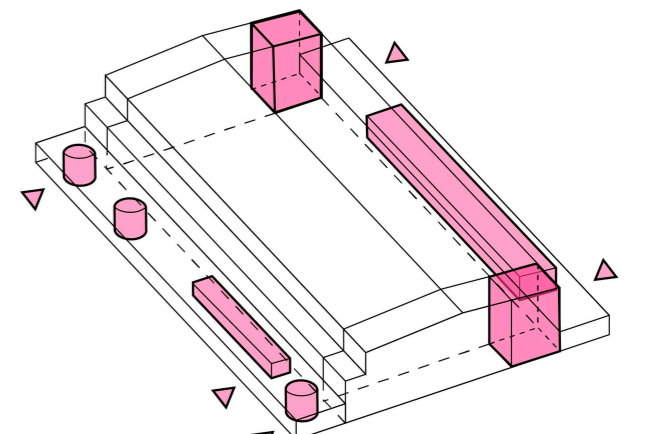

VERTICAL COMMUNICATIONS

THE MAGASIN AT THE H22 AND AFTER IT

Two separated atmospheres are created inside the 405. The upper volume makes the most of the light coming into, being the predominant element of all the activities which take place in this area, all of them related to The Beach.

On the other hand, the ground floor keeps in shadows offering non-ordinary leisure activities. Being called the Dark Beach, it includes flexible spaces where bizarre leisure is the leading actor.

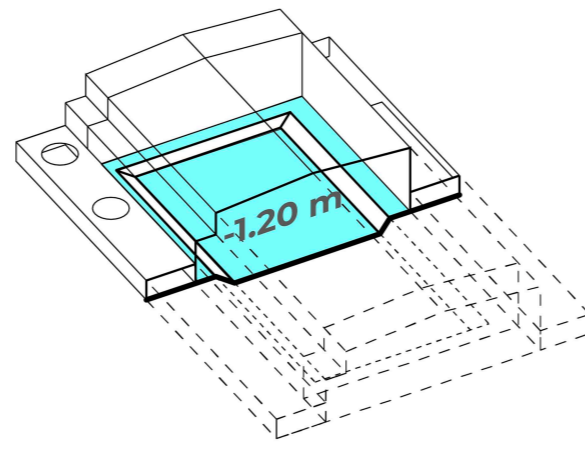
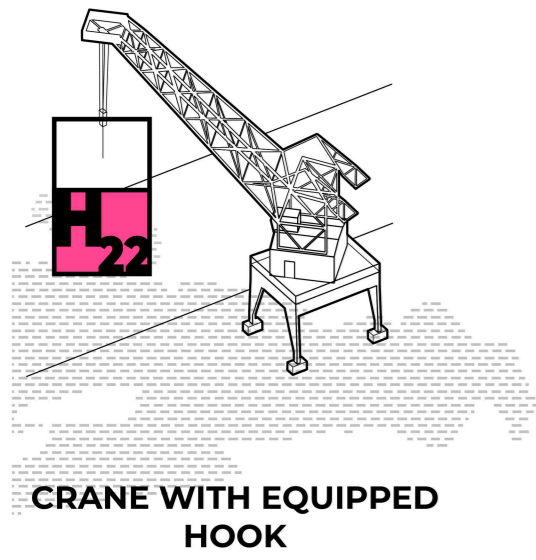
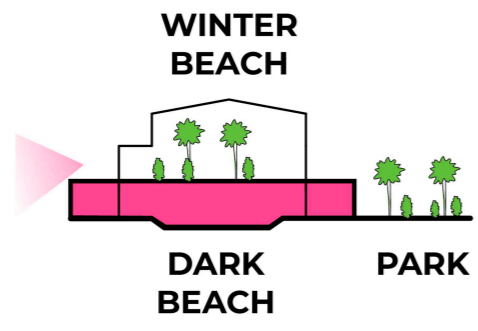
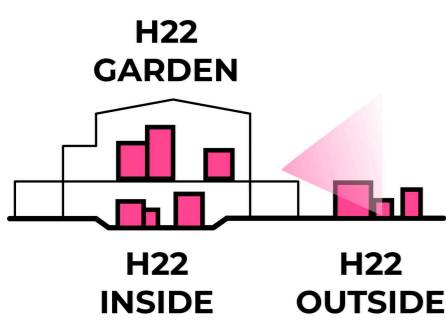

ORIGINAL LEVEL

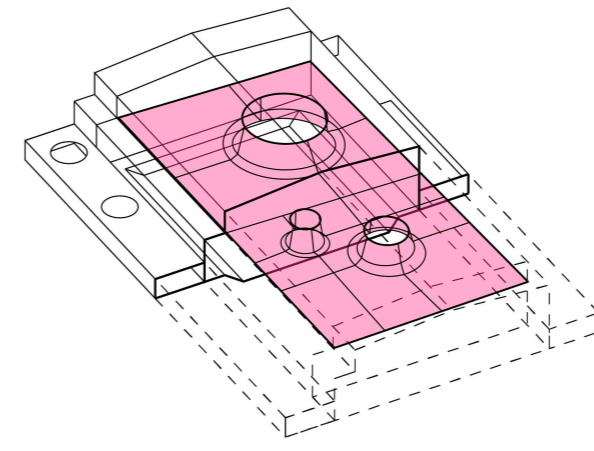

ELASTIC FLOOR

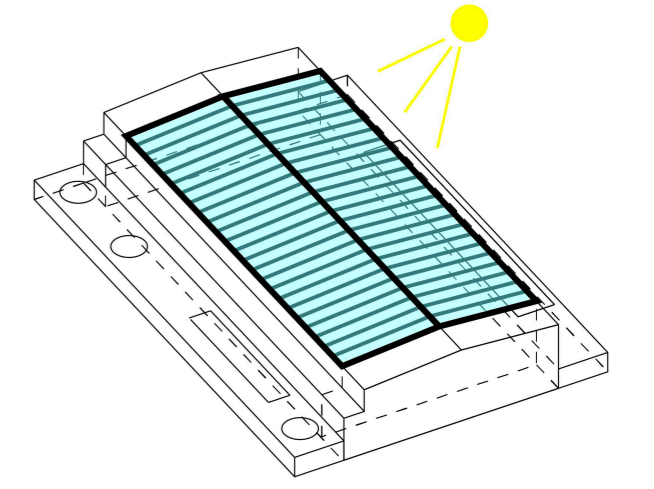

TRANSLUCENT COVER

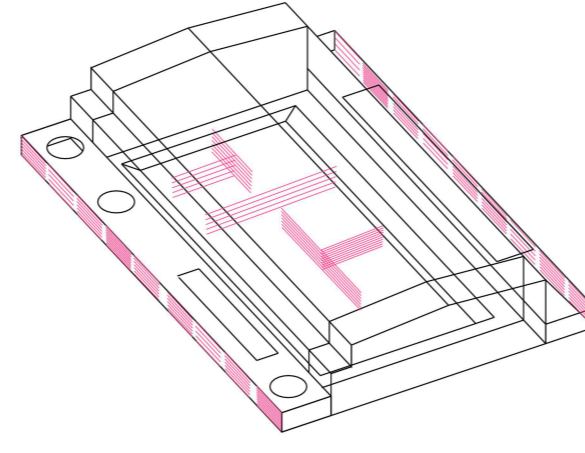

CURTAIN DIVISION

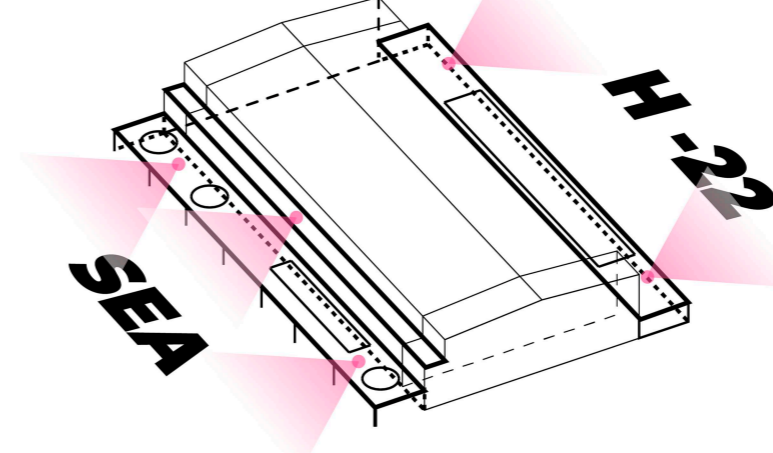

SCENIC VIEWPOINT

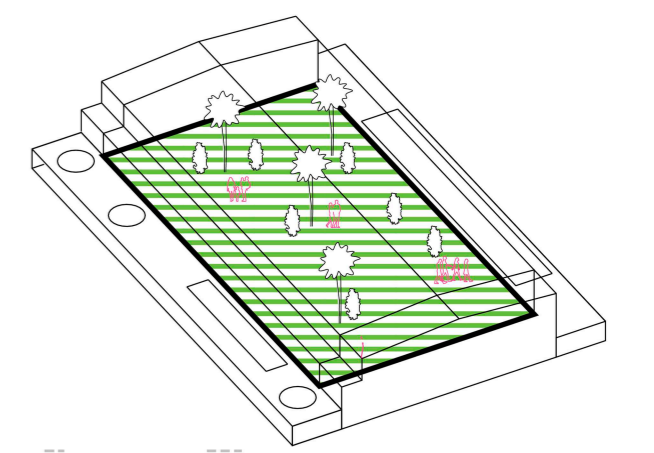

VEGETABLE COLONIZATION

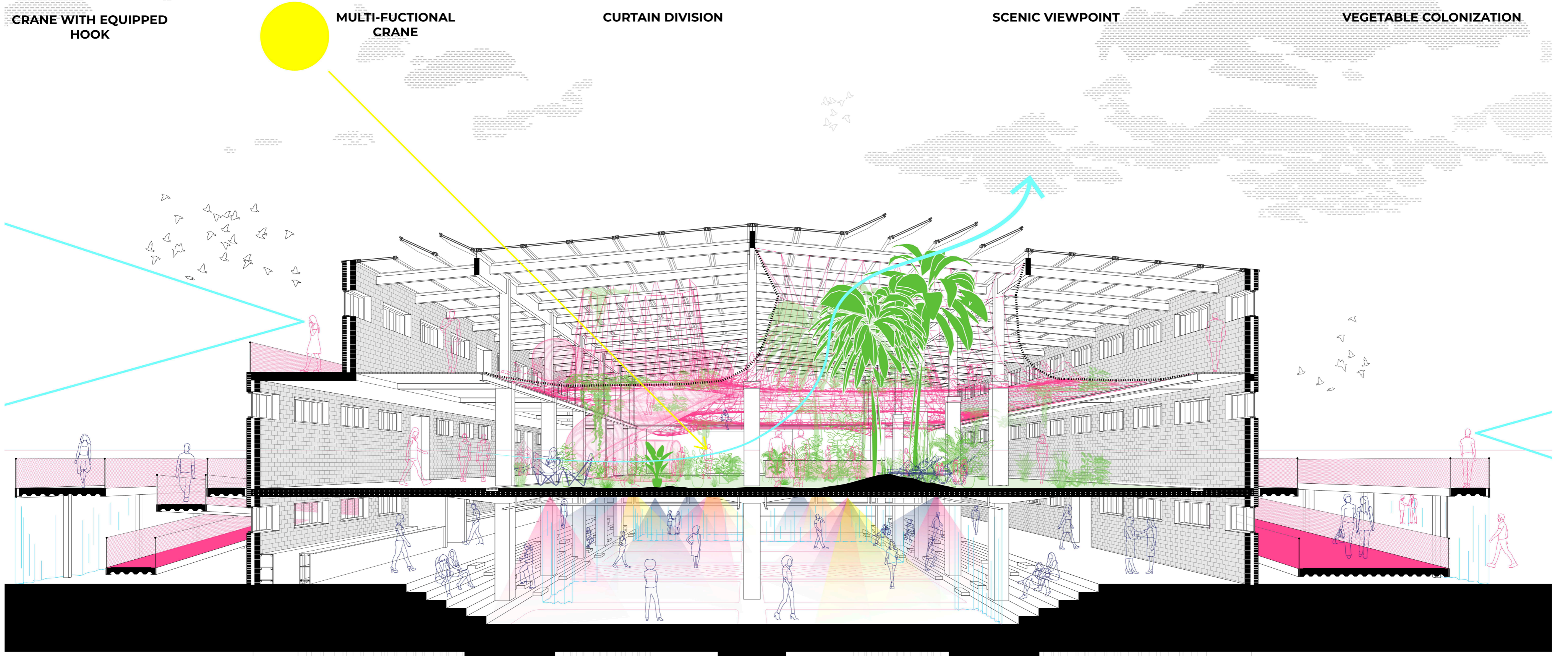

THE DARK SIDE OF THE BEACH when the beach becomes dark

The "dark side of the beach" is a synergy of ephemeral spaces, where the protagonist is not the architectural space, but the experiences themselves as a result of the darkest human relationships.

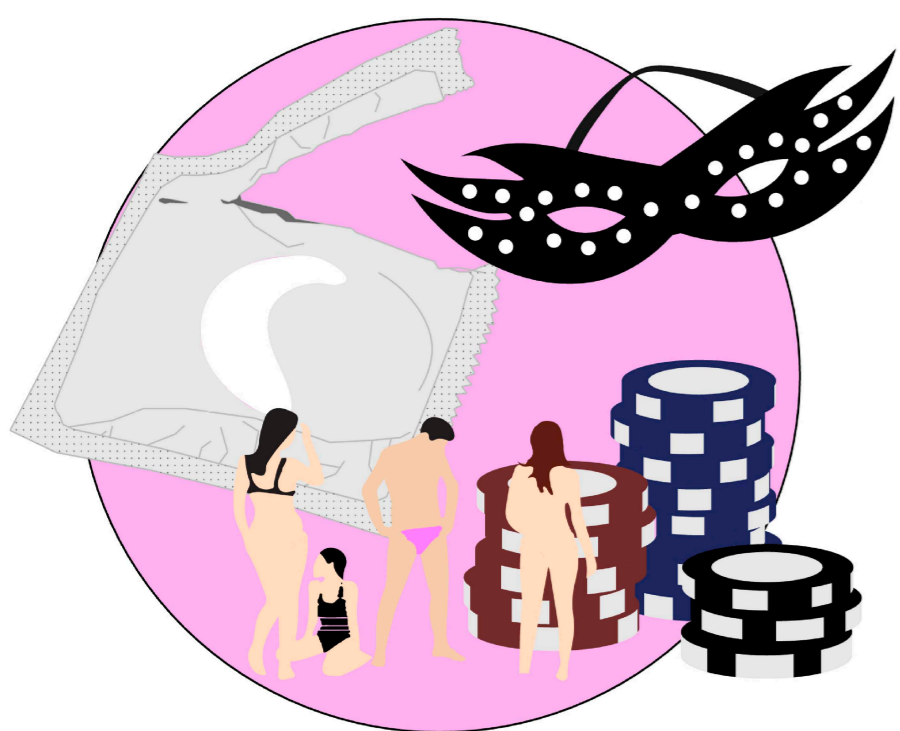

"I'm gonna make him an offer he can't refuse"
The Godfather



"Carpe diem. Seize the day, boys. Make your lives extraordinary"
Dead poets society



"Louis, I think this is the beginning of a beautiful friendship"
Casablanca



"He looked at her the way all women want to be looked at by a man"
The great Gatsby