



## Creating the Generous City

ULLNA CITY: MIX MORE - MOVE MORE - MEET MORE

The Generous City offers a positive vision for the productive city of the future. Based on the topics of resources, mobility and equity the proposal suggests three strategies to develop productive cities; **MIX MORE**, **MOVE MORE** and **MEET MORE**. The strategies are applied on an urban scale, as well as to every block in the development. Within the strategies, new and traditional urban planning tools are used to transform the existing large scale and car-bound

monoculture into a mixed, dense and rich structure where people live, work and relax. The allowing and inviting environment will build the city of the future where everyone is welcome, and everyone will be able to contribute. The Generous City is a place where people gather, produce and share.

The Generous City shows a way to transform an urban monoculture into a smart ecosystem. An extension of an existing

generic grid forms a base where buildings, functions and vegetation can develop step by step over time. Nature and urbanity intervene to form a city that is generous with green qualities and is tolerant to climate change and extreme weather. The large Generous Park in the very centre of the development plays an active part in maintaining the ecological balance as well as to encourage a sustainable lifestyle. The public spaces are designed to absorb water in streets, squares

and courtyards. Technical solutions are made visible to inform and encourage people. The Generous City is resilient.

Arninge-Ullna is a rapidly changing district along the highway artery north of Stockholm. The area was established in the 70's as an island of car-based production and shopping interspersed between beautiful landscapes - but with poor connection to them. On the site today, there is a motocross track, an

ornament of the car which will now close to make space for a mix-used city district where existing small-scale production and shopping will merge with housing, schools, recreation, sports and office spaces. Ullna City - the new city part in Täby - is an example of the Generous City as a changing metabolism. Using the proposed strategies, the modernist city will transform into a generous and productive city of the future.



Large Scale Implementations

### MIX MORE - A strategy of resources

MIX MORE: Reusing residual heat from the existing light industries in the area for warming bike paths. Keeping parts of the existing forest to add surplus value.

### MOVE MORE - A strategy of mobility

MOVE MORE: Easily accessed city part, connected to the existing grid by extending the existing street grid and adding green connecting streets across the site. Connecting Ullna City to its surroundings by foot, bike and public transport such as Roslagsbanan.

### MEET MORE - A strategy of equity

MEET MORE: Creating and connecting to attractive non commercial spaces. Safe and lively public space with meeting spaces for all such as squares and plazas.



Medium Scale Implementations

MIX MORE: Exchange of goods and services with attractive re-use stations for promoting a cradle to cradle lifestyle. "Sponge city" - absorbing water and providing nature and vegetation habitats for animals and plants. Dwellings are heated using excess heat from offices and businesses. Buildings are used by different user groups over the course of the day.

MOVE MORE: Green main streets for pedestrians and bikes only. Bike paths are promoted in the structure and heated in the winter. Power Bar - a place for creating and sharing energy. Mobility hubs for parking, charging and loaning sustainable vehicles. Use of electric vehicles is encouraged.

MEET MORE: The city is designed with easily accessed public space, with special focus on girls and elderly. Safe and inviting recreational squares and parks.

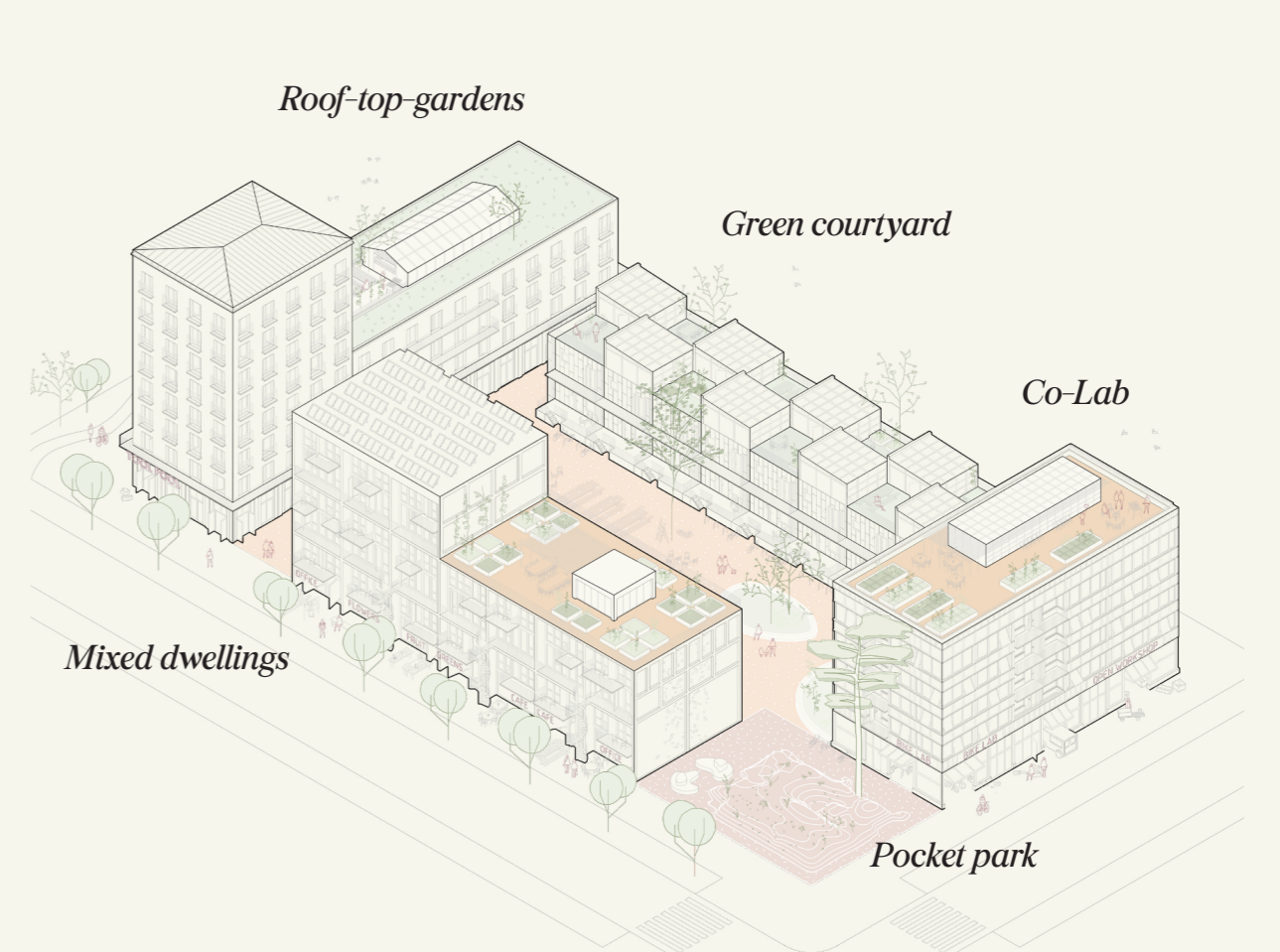

Small Scale Implementations

MIX MORE: Sharing! Each block has a pool for tools, clothes, or vehicles etc making it easy to share and re-use. All buildings and city parts are activated by different users around the clock. Flexible buildings with generous floor heights making it easy to use for different purposes.

MOVE MORE: Safe and generous spaces for pedestrians. Easy access to bike parking, charging for electric cars and other sustainable vehicles.

MEET MORE: Mixed forms of dwellings, the possibility to live your entire life in the Generous City, moving between apartments, row houses and elderly care. Co-Labs; buildings with spaces for co-working and co-living and a ground floor open to the public.