

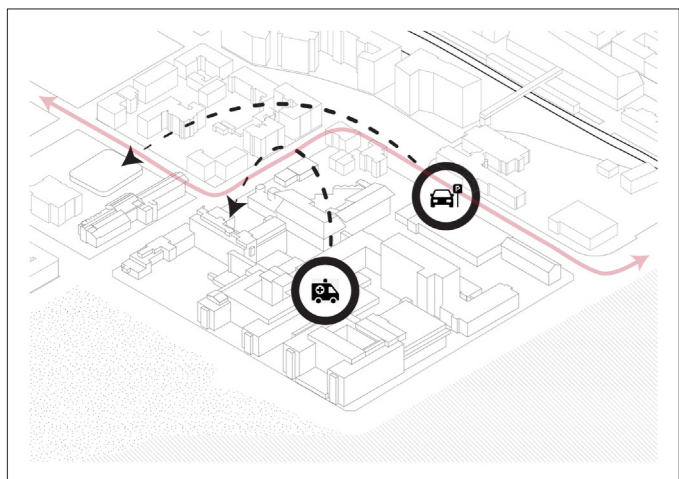

SITE STRATEGIES & IMPLEMENTATION

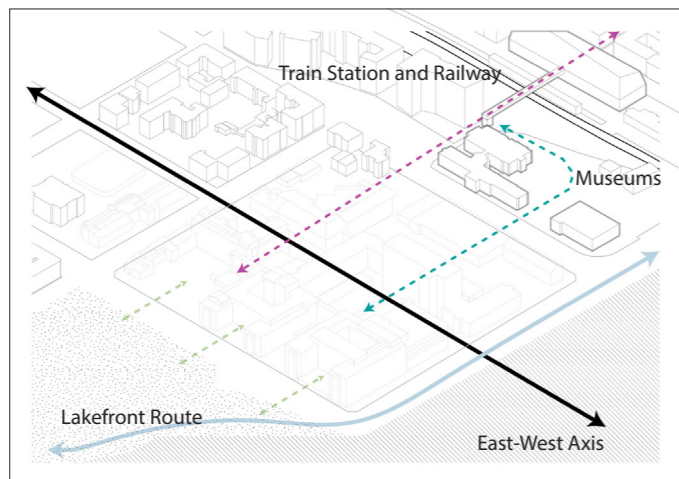

Transfer of Parking & Emergency
Following the limitation of cars in the city, the space occupied by car parking is also reduced, transferring part of it to the parking already present on the other side of site.



Strategic Permeability
Key strategic interventions to facilitate permeability arise from links already implied by the site.

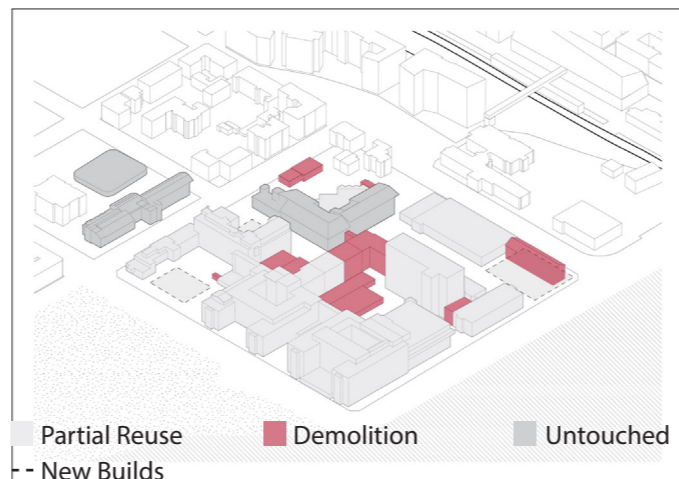

Gradient Intervention
The reuse strategy goes hand in hand with the main links that need to be created. A gradient of interventions is established to support a long-term vision of adaptation.

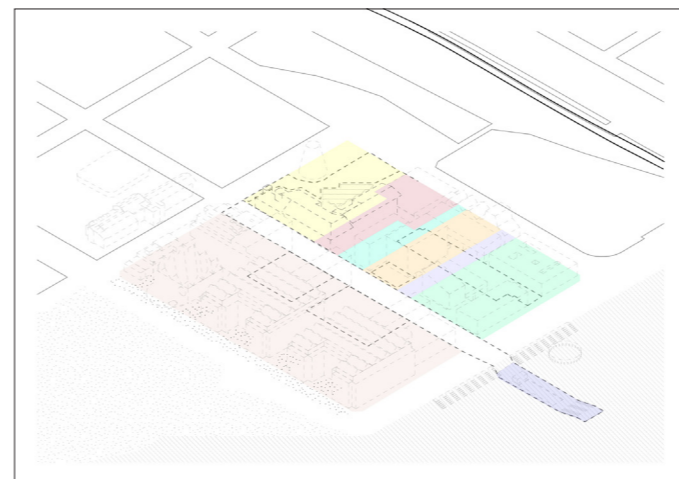

Breaking the Superblock
With the guidance of the new routes, an array of plot sizes and characters are created. Instead of strict zoning, plots are interrelated with one another, creating a fluid space at the ground level.

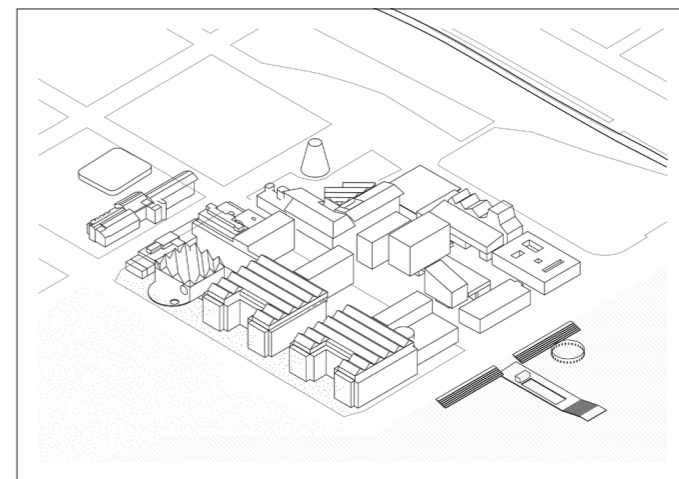

Assemblage of Forms
Through the new builds and reuse strategies, an array of forms are created with different facades and heights. This reflects the hybridity of the new area.

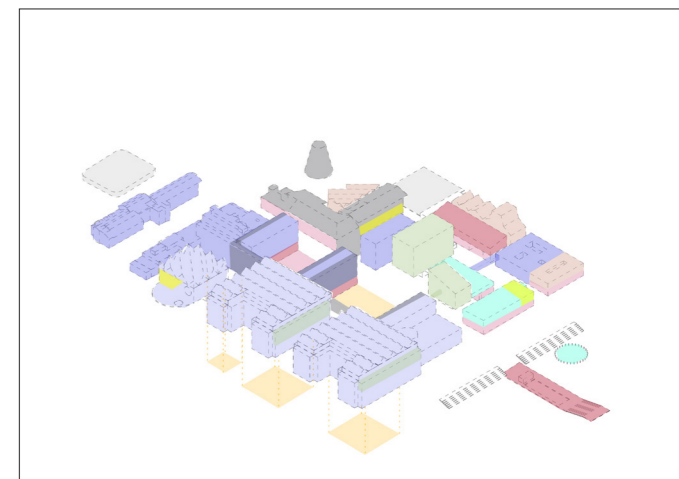

Hybridity of Functions
While at first glance the site may seem like its divided into 2 zones, an x-ray look into the buildings show that each volume contains an amalgam of programs that support a new care landscape.

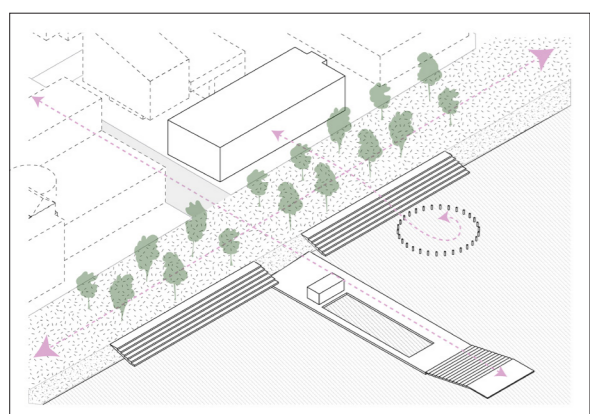

Outdoor Recovery
In order to fasten the recovery of rehab patients and create better conditions for the geriatric wing, the volume is directly connected to sport activities in the lake.

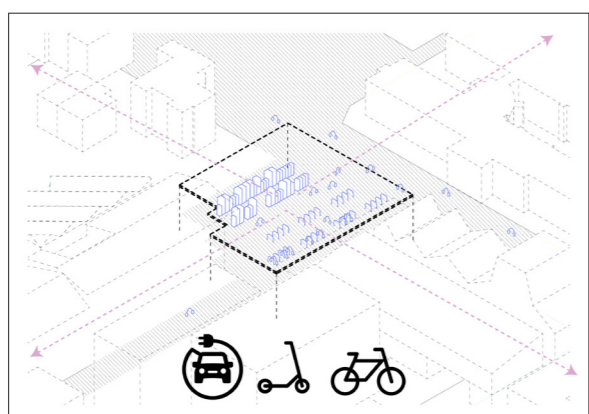

Mobility Hub
Integrating multiple transportation options, such as buses, trains, bikes, and rideshares.

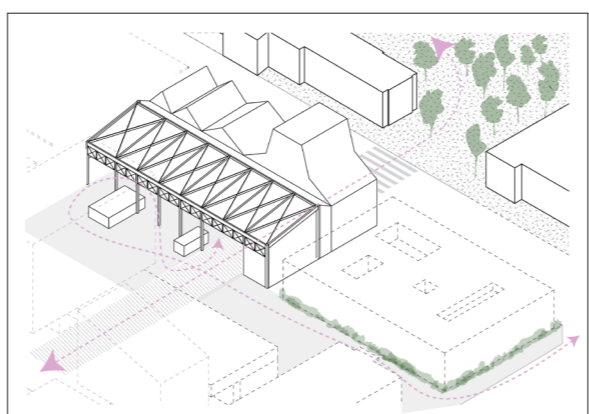

Civic Buffer Zone
A civic buffer zone is created on the north side by the reuse of the car park structure, opening up the axis that follows the museums through a tunnel-like entrance.

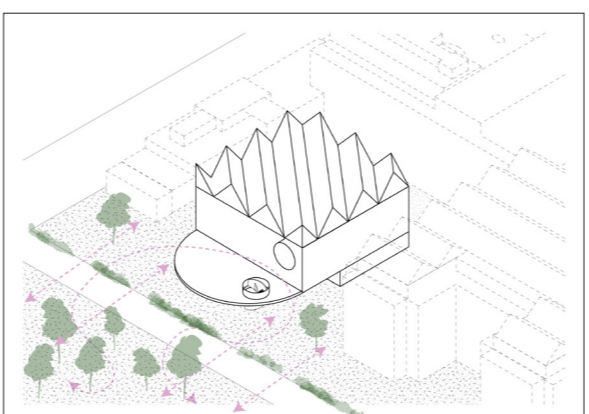

Pediatric Wing
The new building prioritizes children's well-being, harmoniously blending indoor and outdoor spaces to foster a comforting atmosphere for their recovery.

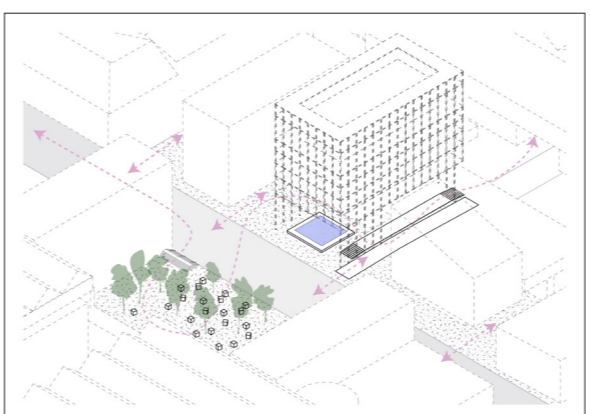

Transitional Spaces
Transitional spaces along the axis are created by the negative space of the buildings. Through this, the linear rigidity is broken to allow for lingering and passing through.

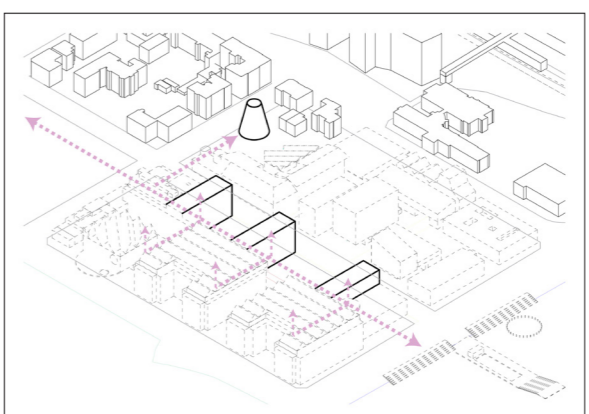

Automated Subterranean Logistics
Use of robotic systems to move medical supplies, equipment, and waste efficiently.

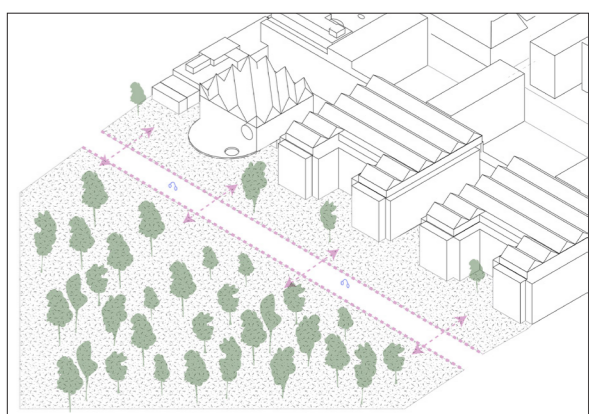

Green Buffer Zone
The pedestrianisation of the final part of Södra Esplanaden ensures the connection between Strandbjörket park and the open courtyards of the hospital.

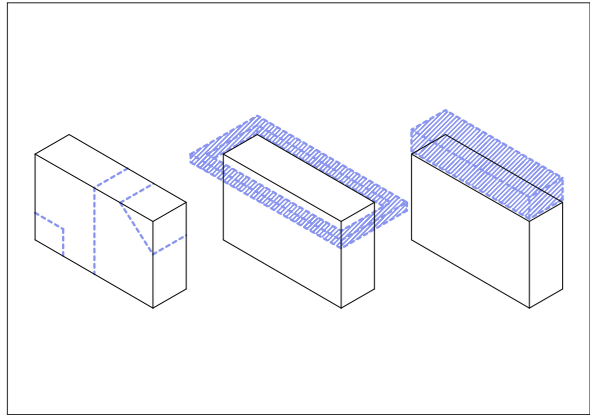

Reuse Strategies
The reuse of the buildings are done through incisions, additions and filters.

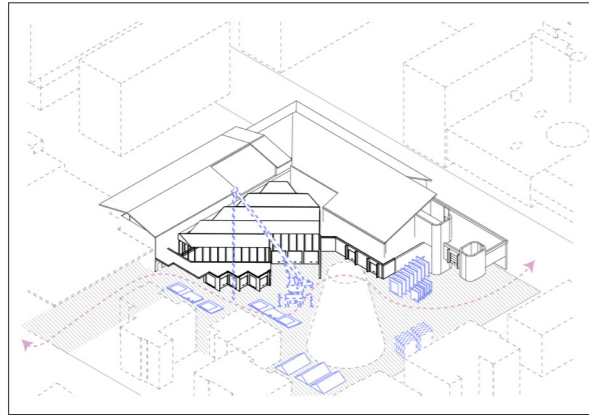

Recycling Hub and Makers Space
The reconversion of this building is used temporarily as a place to manufacture building parts and then permanently to a makers space and waste management hub

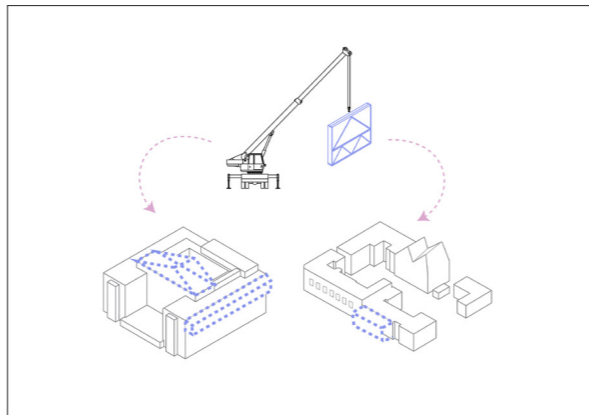

Reuse and Repair
The production of building parts on site is used both for the reuse activities in the hospital and elsewhere in the city.

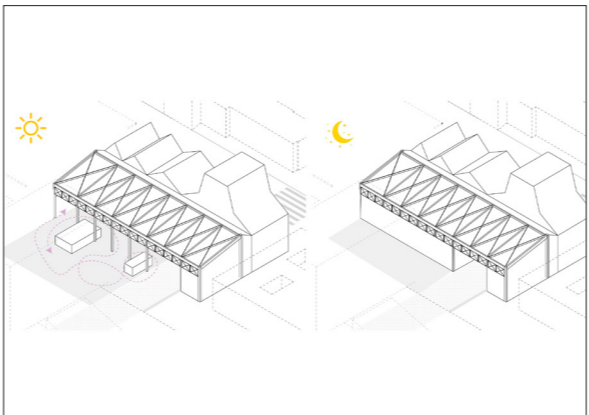

Changing Rhythms
At times, the proposal uses flexible structures to facilitate mixed use civic spaces in the daytime and maintain security at night. Main axis always stay open for accessibility.

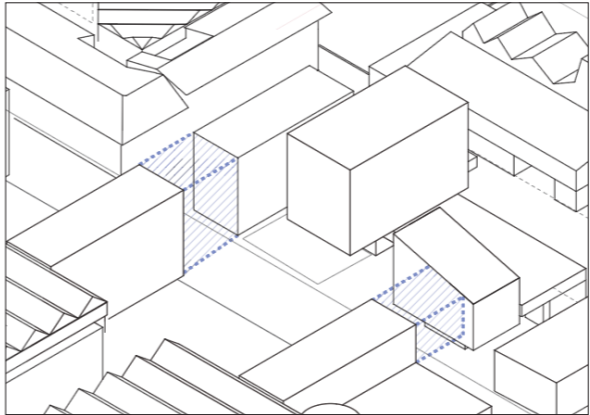

Controlled Demolition
By retaining existing structures, and preferring adaptive reuse, limited demolition reduces the environmental impact associated with construction and waste generation.

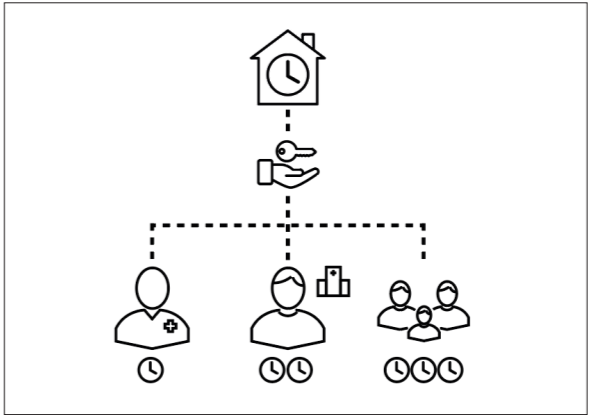

Residential Program
In collaboration with the municipality, residential functions can be introduced in the site, with special temporary leasing.

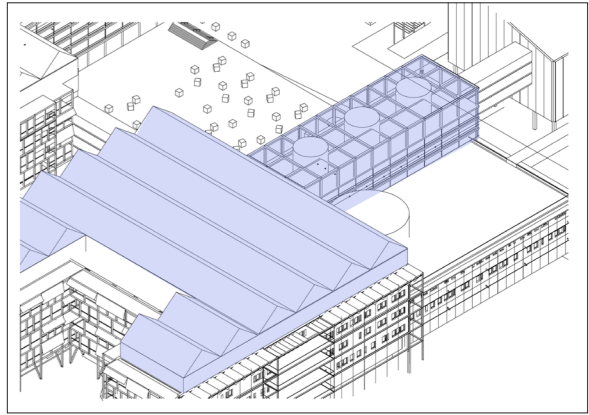

Self-Sufficiency
The self-sufficient building incorporates water collection systems for reuse, harnesses solar power for energy needs, and utilizes a wind turbine.

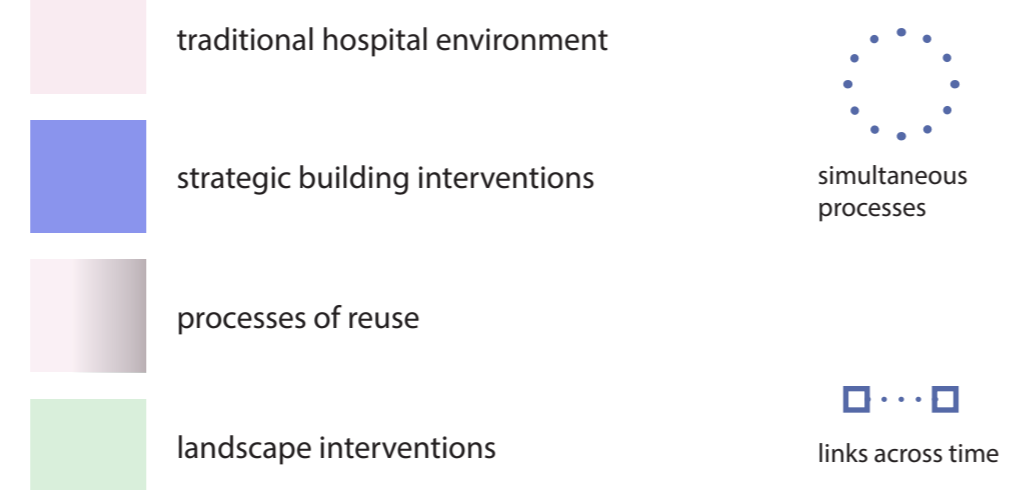
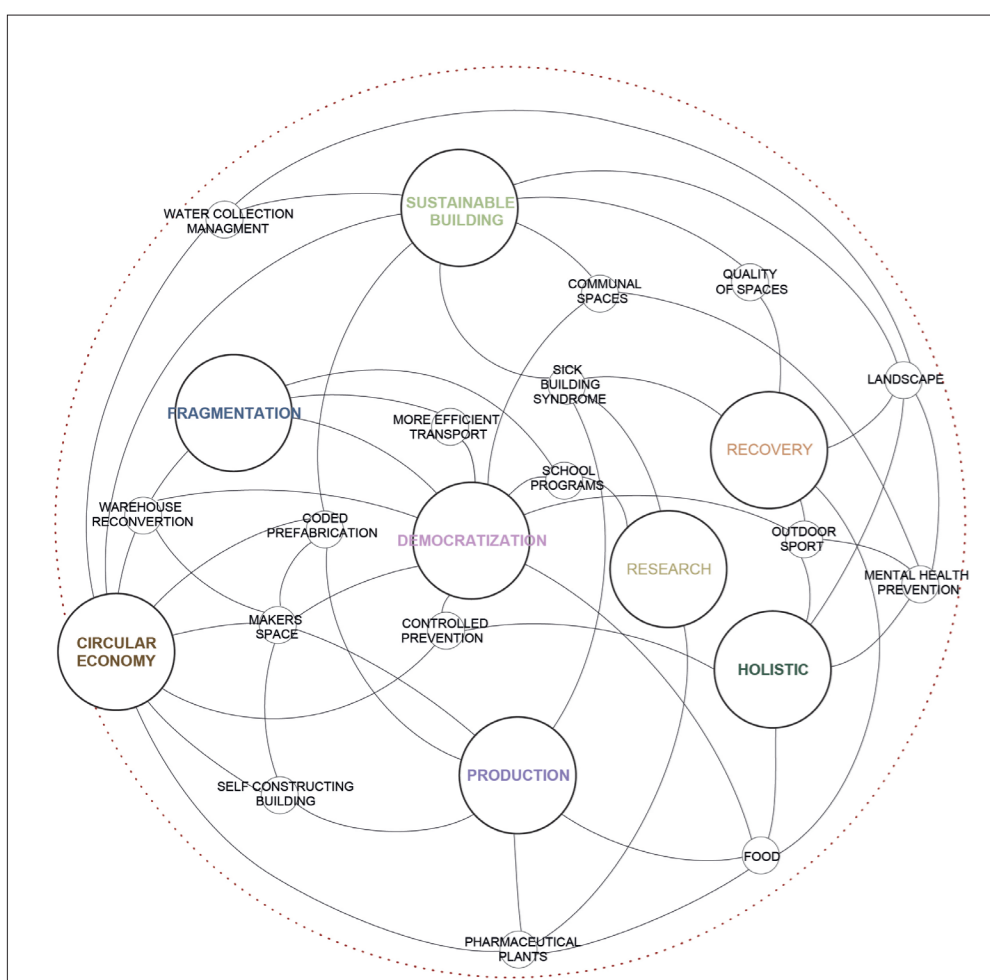

Phasing Strategy
Despite having a linear implementation route, the phasing strategy is based on strategic points and processes that connect various parts of the site to one another in a non-linear fashion across time. Aiming to activate a widening array of stakeholders, the phasing oversees the hospital turning into an a hybrid environment with processes of reuse, new building activities and landscape strategies making it a more integral part of the city.

